

HI-CLASS TOP 45 IB ACWG UV LED KL

HI-CLASS TOP 45 IB ACHWG UV LED KL

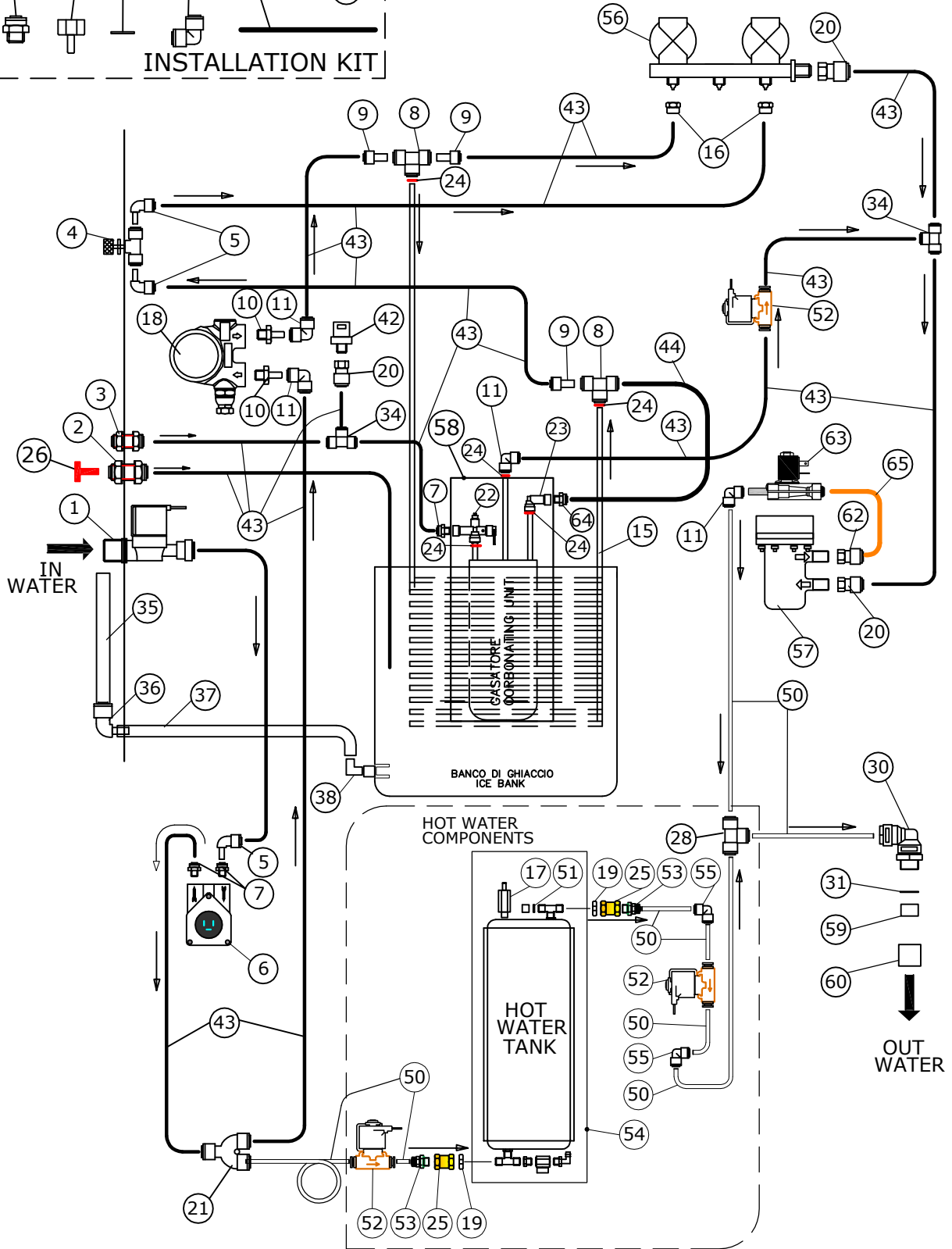
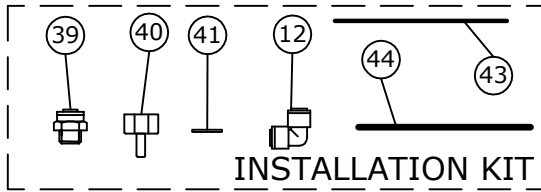

2				
1				
		MACCHINA HI-CLASS TOP 45 IB ACWG UV LED KL HI-CLASS TOP 45 IB ACHWG UV LED KL		
Data:		11-6-2024	Descrizione	
		HYDRAULIC DIAGRAM <small>Note.</small>		

HI-CLASS TOP 45 IB ACWG & ACHWG UV LED KL HYDRAULIC

ITEM	P/NUMBER	DESCRIZIONE 	DESCRIPTION 
1	210095	ELETTROVALVOLA DI INGRESSO 3/4M-6 230V	INLET SOLENOID VALVE 3/4M-6 230V
	226880	ELETTROVALVOLA DI INGRESSO CEME ALTERNATIVA 3/4M-6 230V	ALTERNATIVE CEME NLET SOLENOID VALVE 3/4M-6 230V
2	272073	PASSAPARETE 8-6	BULKHEAD CONNECTOR 8-6
3	068501	PASSAPARETE 6-6 NC2478-P	BULKHEAD CONNECTOR 6-6 NC2478-P
4	304488	REGOLAT. DI FLUSSO 6-6 PER FREDDA	FLOW REGULATOR 6-6 STILL WATER
5	272105	GOMITO CODOLO 6-6 PM220606E	STEM ELBOW 6-6 PM220606E
6	208127	CONTALITRI IN PLASTICA 1/4FF	PLASTIC FLOWMETER 1/4FF
7	008642	DRITTO 1/4M-6 PM010612E	STRAIGHT 1/4M-6 PM010612E
8	271984	RACCORDO T 8-8-8 PM0208E	T FITTING 8-8-8 PM0208E
9	272104	RIDUZIONE DRITTA CODOLO 8-6 PM060806E	STRAIGHT REDUCTION STEM 8 TUBE 6 PM060806E
10	007446	DRITTO 3/8M-CODOLO 8 PM050813E	STRAIGHT 3/8M-STEM8 PM050813E
11	272034	RIDUZIONE GOMITO 8-6 PM210806E	REDUCTION ELBOW 8-6 PM210806E
12	272166	GOMITO 8-8 PM0308E	ELBOW 8-8 PM0308E
15	302766	SERPENTINA D.8 - 45 L/H	SERPENTINE D.8 - 45 L/H
16	208168	GHIERA	NUT
17	222392	VALVOLA DI SFIATO IN OTTONE 14 BAR DEL SERBATOIO CALDO	BRASS SAFETY PRESSURE VALVE 14 BAR OF THE HOT TANK
18	304227	POMPA 100 L/H DI OTTONE 3/8FF	BRASS PUMP 100 L/H 3/8FF
19	306682	DADO DA 1/4	NUT 1/4
20	208119	RACCORDO 1/4F-6 PM450612E	FITTING 1/4F-6 - PM450612E
21	046603	RACCORDO Y 6-6-6 RM2306E	FITTING Y 6-6-6 RM2306E
22	304368	RACCORDO ENTRATA CO2	CARBONATING CO2 INLETPIPING (SPARE PART)
	304410	GASATORE DI NON RITORNO DW10	CHECK VALVE DW10
	304902	SONDA 112 mm + BOCCOLA	112 mm PROBE + BUSH
	304902	VALVOLA SICUREZZA	SECURITY VALVE
23	304369	RACCORDO ENTRATA ACQUA GASATORE (RICAMBIO)	CARBONATING WATER INLET PIPING (SPARE PART)
	304410	VALVOLA DI NON RITORNO DW10	CHECK VALVE DW10
24	053845	CLIP 5/16	CLIP 5/16
25	210101	MANICOTTO 1/4FF IN OTTONE	FITTING 1/4FF
26	272074	TAPPO DA 8	CLOSURE DIAM.8
28	304448	T DA 6 BIANCA PER ALTA TEMP.	WHITE TEE HIGH TEMP. 6-6-6
30	304272	GOMITO 3/8M-6	ELBOW 3/8M - 6
31	304943	GUARNIZIONE AERATORE	GASKET FOR AERATOR
34	304286	TEE 6 PM0206E	TEE 6 PM0206E
35	305744	TUBO 7X10 PVC TRASP.	PVC TRANSPARENT PIPE 7-10
36	304397	GOMITO CODOLO 10-10 PM221010E	STEM ELBOW 10-10 PM221010E
37	272097	TUBO SILICONE PEROSSID. 12-8	PEROXIDIC SILICON PIPE 12-8
38	208114	CURVA BIANCA	SMALL WHITE ELBOW
39	272982	ADATTATORE DRITTO 3/8M-8 PM010813E	STRAIGHT FITTING 3/8M-8 PM010813E
40	304387	RACCORDO 3/4F-8	FITTING 3/4F-8
41	304953	GUARNIZIONE	GASKET
42	306576	SENSORE PRESSIONE CO2 HI-CL 45	CO2 PRESSURE SENSOR HI-CL 45
43	272038	TUBO PE 6	LLDPE PIPE O.D. 6
44	088113	TUBO 8	LLDPE PIPE O.D. 8
50	305715	TUBO TEFLON DIAM.6	TEFLON PIPE O.D. 6
51	304926	GUARNIZIONE SILICONE ALIMENTARE	SILICON GASKET
52	304869	ELETTROV. 230V 6-6	SOLENOID V. 6-6 230V
53	304420	DRITTO IN OTTONE 1/4M-CALZ.6	BRASS STRAIGHT 1/4M-COMPR.6 OR VITON
54	304780	SERBATOIO CALDO HICL.45 AQ.28	HOT TANK HICL.45 AQ.28
55	304475	GOMITO 6-6 BIANCO PER ALTA TEMPERAT.	WHITE ELBOW 6-6 FOR HIGH TEMPER.
56	208093	ELETTROV. 230V 2IN-1OUT	SOLENOID VALVE 230V 2IN-1OUT
57	304591	REATTORE UV KLARAN	UV REACTOR KLARAN
58	304752	GASATORE 1L 1 SONDA	CARBONATOR 1L 1 PROBE
59	304252	AERATORE	AERATOR
60	304251	BECCUCCIO	NOZZLE
62	304288	DRITTO 1/4F-8 PM450812E	FITTING 1/4F-8 PM450812E
63	214254	ELETTROV. 8-8 230V CON COMPENSATORE	SOLENOID V. 8-8 230V WITH REGULATOR
64	007362	DRITTO 1/4M-8	STRAIGHT 1/4M-8
65	214772	TUBO RAME DIAM.8	COPPER PIPE O.D. 8

11-06-2024