

RIVER 20-30-55 IB C R134a & R290

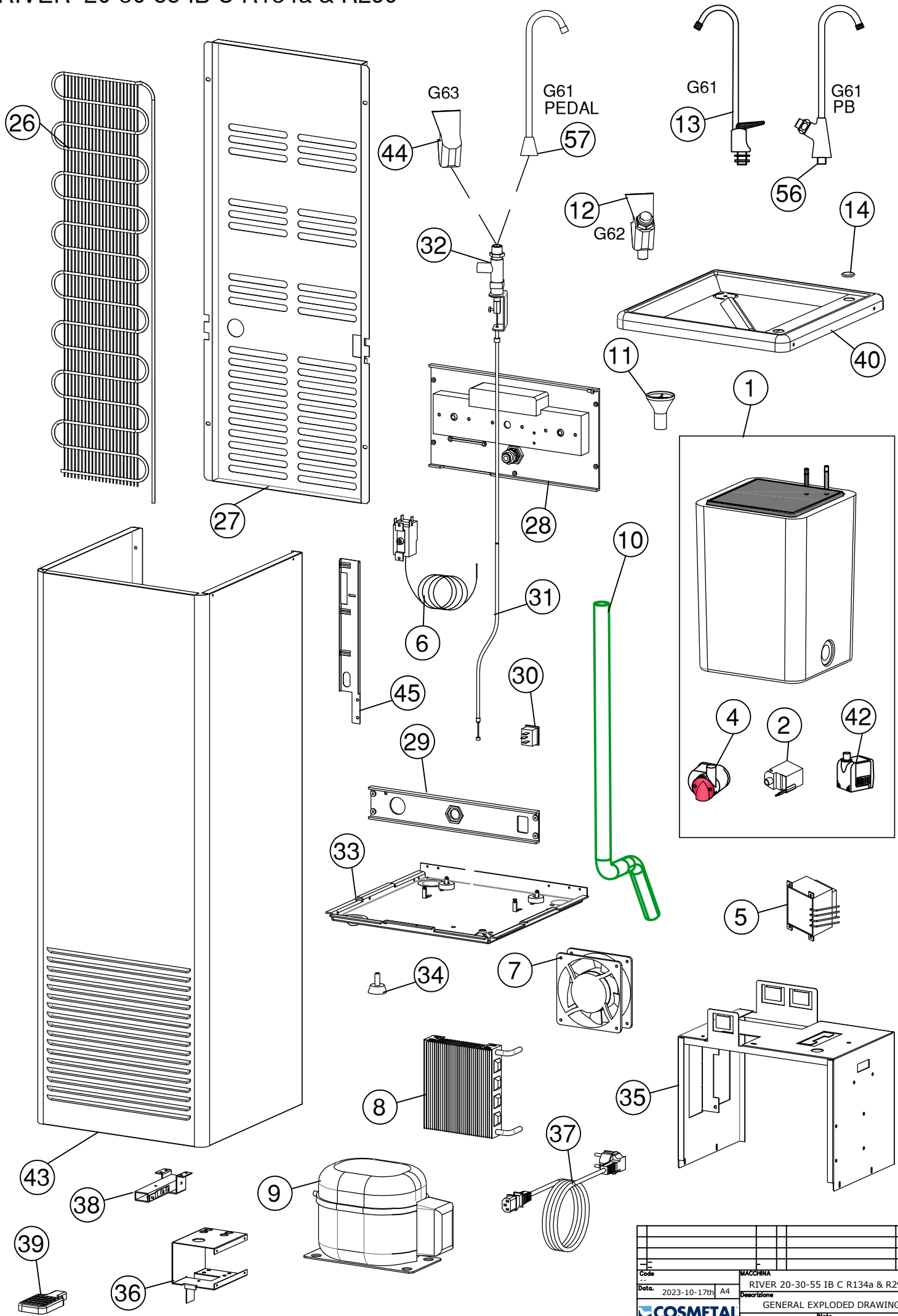

Code	MACCHINA
Data	2023-10-17th A4
Descrizione	RIVER 20-30-55 IB C R134a & R290 GENERAL EXPLODED DRAWING
Nota	

Item	P/NUMBER	DESCRIZIONE	DESCRIPTION 
1	307872	BANCO GH.COMPLETO RIVER 20 230-50 R134a	COMPLETE ICE BANK RIVER 20 230-50 R134a
	215275	BANCO GH.COMPLETO RIVER 20 230-50 R290	COMPLETE ICE BANK RIVER 20 230-50 R290
	307798	BANCO GH.COMPLETO RIVER 20 230-50/60 R134a	COMPLETE ICE BANK RIVER 20 230-50/60 R134a
	272223	BANCO GH.COMPLETO RIVER 30 230-50 R134a	COMPLETE ICE BANK RIVER 30 230-50 R134a
	214978	BANCO GH.COMPLETO RIVER 30 230-50 R290	COMPLETE ICE BANK RIVER 30 230-50 R290
	307877	BANCO GH.COMPLETO RIVER 30 230-50/60 R134a	COMPLETE ICE BANK RIVER 30 230-50/60 R134a
	215041	BANCO GH.COMPLETO RIVER 30 230-50/60 R290	COMPLETE ICE BANK RIVER 30 230-50/60 R290
	272116	BANCO GH.COMPLETO RIVER 55 230-50 R134a	COMPLETE ICE BANK RIVER 55 230-50 R134a
	215191	BANCO GH.COMPLETO RIVER 55 230-50 R290	COMPLETE ICE BANK RIVER 55 230-50 R290
	307883	BANCO GH.COMPLETO RIVER 55 230-50/60 R134a	COMPLETE ICE BANK RIVER 55 230-50/60 R134a
	215211	BANCO GH.COMPLETO RIVER 55 230-50/60 R290	COMPLETE ICE BANK RIVER 55 230-50/60 R290
2	207934	AGITATORE ASKOLL MICROMEGA 230V-50 Hz	AGITATOR ASKOLL MICROMEGA 230V-50Hz
4	302455	AGITATORE HYDOR PICO 100 115V - 60 Hz	AGITATOR HYDOR PICO 100 115V-60Hz
5	306666	TRASFORMATORE 230-100V	TRANSFORMER 230-100V
6	208155	TERMOSTATO > 0°C R134a	THERMOSTAT > 0°C R134a
	214968	TERMOSTATO > 0°C R290	THERMOSTAT > 0°C R290
7	208080	VENTOLA 230V 120x120x38	FAN MOTOR 230V 120x120x38
8	272027	CONDENSATORE	CONDENSER
9	272025	COMPRESSORE 230V - 50/60 Hz R134A	COMPRESSOR 230V-50/60 Hz R134a
	302587	COMPRESSORE 230V - 50/60 Hz R290	COMPRESSOR 230V-50/60 Hz R290
10	208098	TUBO DI SCARICO	DRAINAGE PIPE
11	207929	IMBUTO SCARICO LAVELLO + VITE INOX	COMPLETE FUNNEL, SCREW AND GASKET
12	208154	RUBINETTO G62	G62 FAUCET
	222533	DADO BASSO 3/8	BRASS NUT
	222534	GUARNIZIONE	RUBBER GASKET
13	207927	RUBINETTO G61 KIT COMPLETO CON RACCORDO	G61 FAUCET COMPLETE KIT WITH BRASS FITTING
	222533	RUBINETTO G62	G62 FAUCET
	222534	DAO BASSO 3/8	BRASS NUT
14	308386	TAPPO CROMATO PER LAVELLO	CHROMED CLOSURE FOR SINK
26	302611	CONDENSATORE STATICO	STATIC CONDENSER
27	271971	PANNELLO POSTERIORE	REAR PANEL RIVER
28	271990	TRAVERSA SUPERIORE IN PLASTICA	UPPER PLASTIC PANEL
29	271998	TRAVERSA INFERIORE IN PLASTICA	LOWER PLASTIC BEAM
30	272106	SPINA PER CAVO ALIMENTAZIONE	IEC CONNECTOR FOR POWER CORD
31	272217	CAVO PEDALE	WIRE FOR PEDAL
32	272218	VALVOLA MECCANICA PER G63	COMPLETE MECHANICAL VALVE FOR G63
33	208122	BASE	BASAMENT
34	271999	PIEDINO REGOLABILE	ADJUSTABLE FOOT
35	272115	SUPPORTO ICE BANK RIVER IB	ICE BANK SUPPORT RIVER IB
36	272224	STAFFA PEDALE RIVER IB	PEDAL BRACKET RIVER IB
37	272225	CAVO SCHUKO DRITTO	STRAIGHT SCHUKO POWER CORD
	208187	CAVO UK DRITTO	STRAIGHT UK POWER CORD
38	272213	STAFFA PEDALE	BRACKET FOR PEDAL
39	308400	PEDALE RIVER	RIVER PEDAL
40	207945	LAVELLO RIVER	RIVER SINK
42	227078	AGITATORE NEWA MC450 230V 50/60Hz	AGITATOR NEWA MC450 230V 50/60Hz
43	208162	INVOLUCRO C6	CHASSY IN ST.STEEL (C6)
	208163	INVOLUCRO C8	CHASSY IN SKINPLATE (C8)
	302779	INVOLUCRO C6 PER PEDALE	CHASSY IN ST.STEEL (C6) FOR PEDAL
	272220	INVOLUCRO C8 PER PEDALE	CHASSY IN SKINPLATE (C8) FOR PEDAL
44	272212	RUBINETTO G63 COMPLETO	COMPLETE G63 FAUCET
	309583	BOTTONE CROMATO PER G63	CHROMED CLOSURE FOR G63
45	272120	SUPPORTO TUBO LIVELLO	LEVEL TUBE SUPPORT
56	272190	G61 PUSH BUTTON	G61 PUSH BUTTON
57	304656	G61 PER PEDALE	G61 FOR PEDAL